

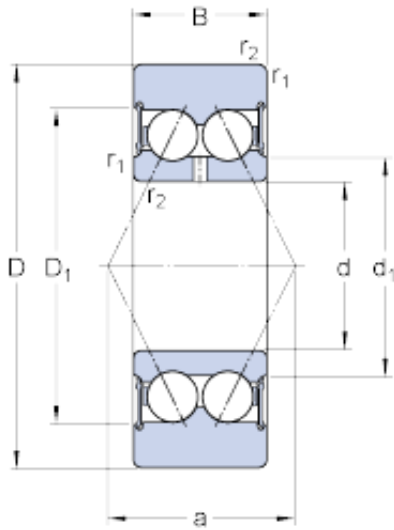

Jinan LBR Bearing Co., Ltd.



305707 C-2RS1 Bearing 2D drawings and 3D CAD models

35 mm x 80 mm x 27 mm SKF 305707 C-2RS1 deep groove ball bearings

Bearing No. 305707 C-2RS1

Size	35x80x27 mm
Bore Diameter	35 mm
Outer Diameter	80 mm
Width	27 mm
D	80 mm
d	35 mm
B	27 mm
d ₁	45.4 mm
D ₁	63.9 mm
r _{1,2} - min.	1.1 mm
a	42 mm
Basic dynamic load rating - C	31.9 kN
Basic static load rating - C ₀	20.4 kN
Fatigue load limit - P _u	0.865 kN
Maximum dynamic radial loads - F _r	max. 15.6 kN
Maximum static radial loads - F _{0r}	max. 22.4 kN
Limiting speed	4300 r/min
d ₁	45.4 mm
D ₁	63.9 mm
r _{1,2} min.	1.1 mm
Basic dynamic load rating C	31.9 kN
Basic static load rating C ₀	20.4 kN



Jinan LBR Bearing Co., Ltd.

Fatigue load limit P_u	0.865 kN
Maximum dynamic radial load F_r max.	15.6 kN
Maximum static radial load F_{0r} max.	22.4 kN
Mass cam roller	0.65 kg